

# The Bintang Urban Loop

Osman Mohd Tahir

Jalan Bukit Bintang which is situated in the heart of the capital city of Malaysia, Kuala Lumpur, has been transformed as one of the busiest shopping heaven over the past few years. It offers tourists as well as locals a variety of merchandise that suit every taste and budget. The famous Bintang Walk is located along this road which has been filled up with various shopping complexes including cafes, restaurants, clubs, shops and malls.

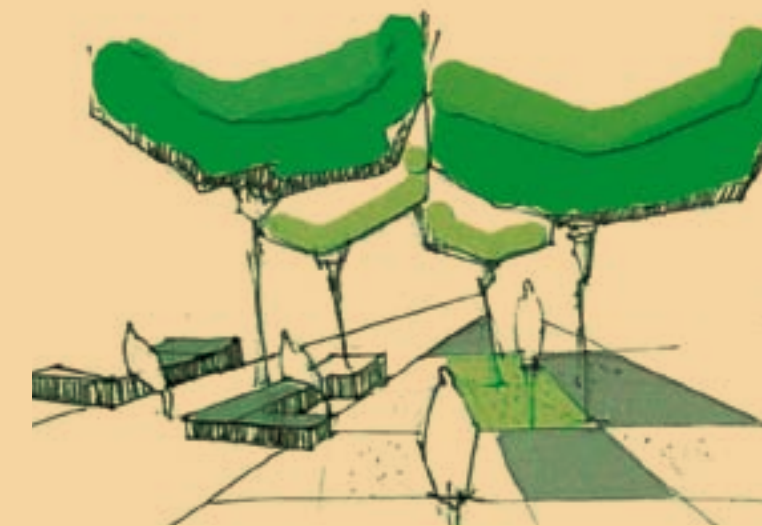
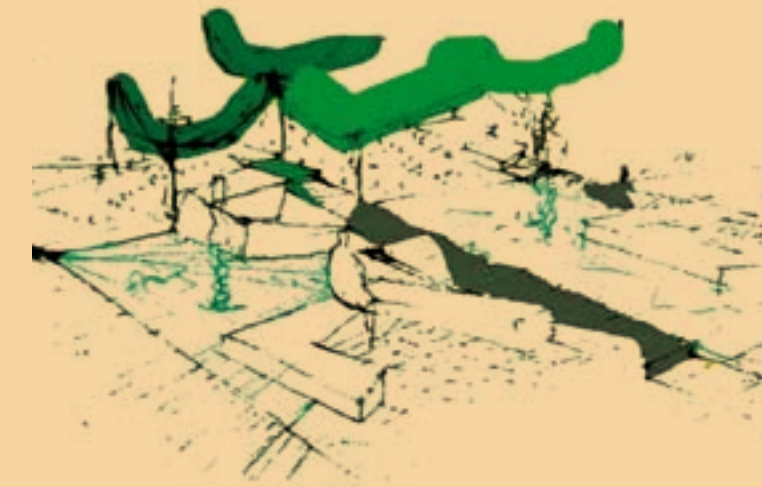
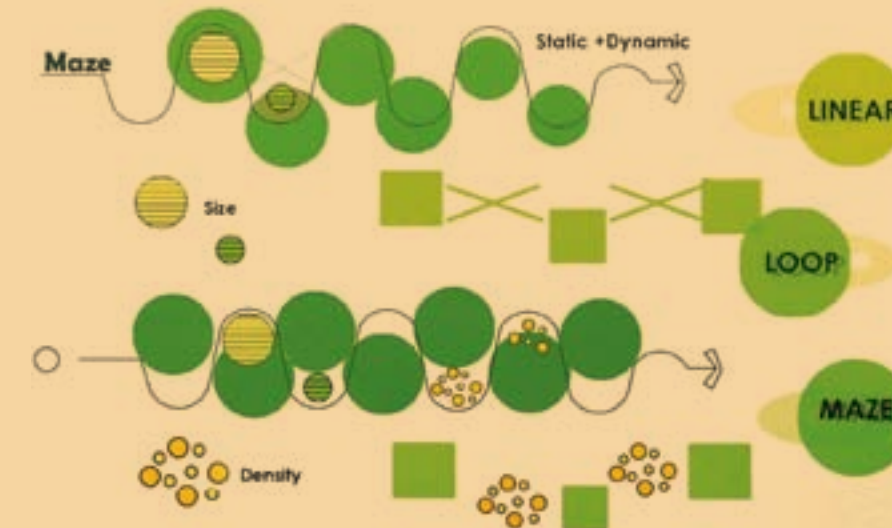
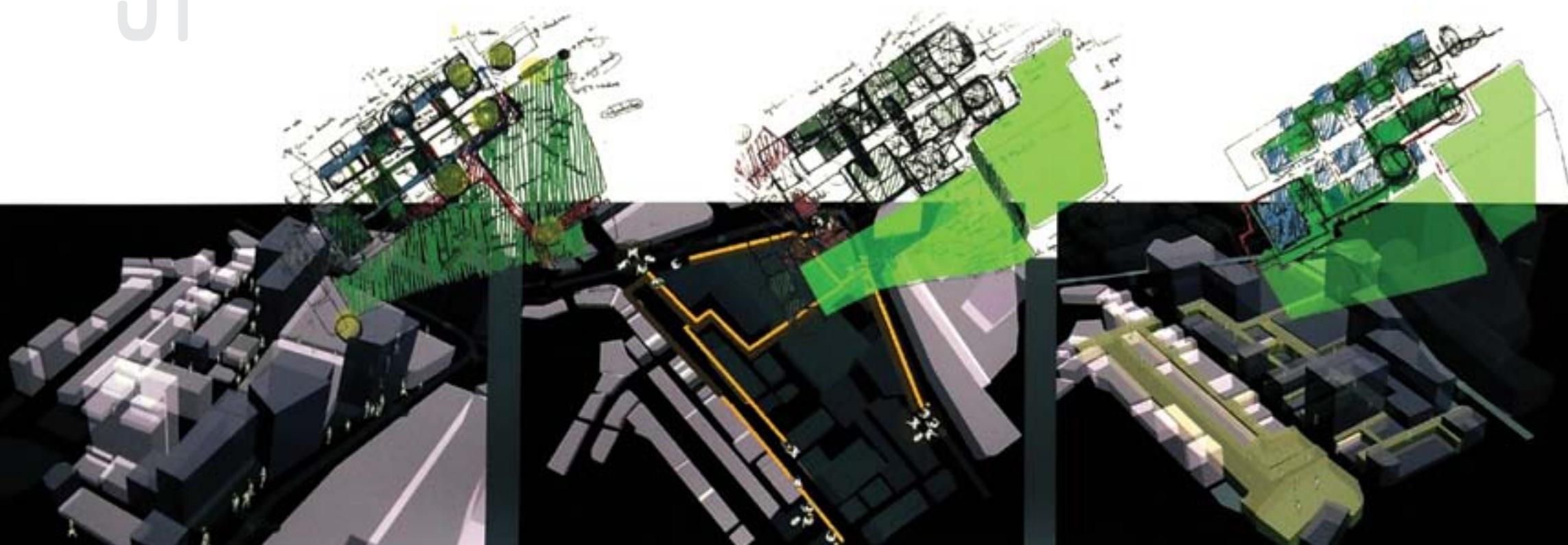

Maryam Sadeghi

However, through rigorous survey and analysis done by Maryam Sadeghi, it is noticed that the site needs to have a system, a hierarchy and connectors between spaces for pedestrian purposes. Therefore, the aim of this project is to improve and upgrade the pedestrian movement of Jalan Bukit Bintang through the concept of kinetic landscape which blends the urban area with mall and green to turn it into a Bintang Urban Loop. The design objective is to provide a conducive and favourable walking environment to attract tourists and locals which will eventually offer better business to the area. At the same time, it aims at reducing the amount of traffic especially private vehicles, reducing crime and creating more interaction between the indoor spaces and the outdoor surrounding environment.

Civic spaces are the key features of the overall urban design of this area and are being integrated into the comprehensive landscape pedestrian network. Maryam Sadeghi initiates the idea of bringing green to the urban area. She demonstrates the idea by blending the green with the urban context. This is done by introducing green walls, turf pavement, hanging green bridge and green cooling benches at different levels of the site. The fragmentation of the solid and void areas creates movement which simultaneously static and dynamic. The introduced maze creates spaces along the path. At the same time, the void spaces with different hierarchy and sizes are turned into green vertical wall. The loop cycle created between these spaces would eventually encourage pedestrian movements. Since crime is an important issue of concern, the design stresses and promotes the feeling of safety which will motivate pedestrian use of these spaces. Planting concept in this project emphasises on safety issues by selecting plants which are layered, penetrable with clear trunk and loose foliage which could provide visual connection along the way. This overall design idea supports the concept of sustainability in the tropical urban context.