

Dimension of Meaning

Abdul Rahim Mohd. Zin & Mohd Fakri Zaky Ja'afar

The scheme promotes exploration of spaces and displayed artifacts as equal importance. The emotion created in the interior space exploration is often forgotten by designers as they tend to focus more on exterior matters. Architecture should encompass all – the exterior, the interior and the landscaping.

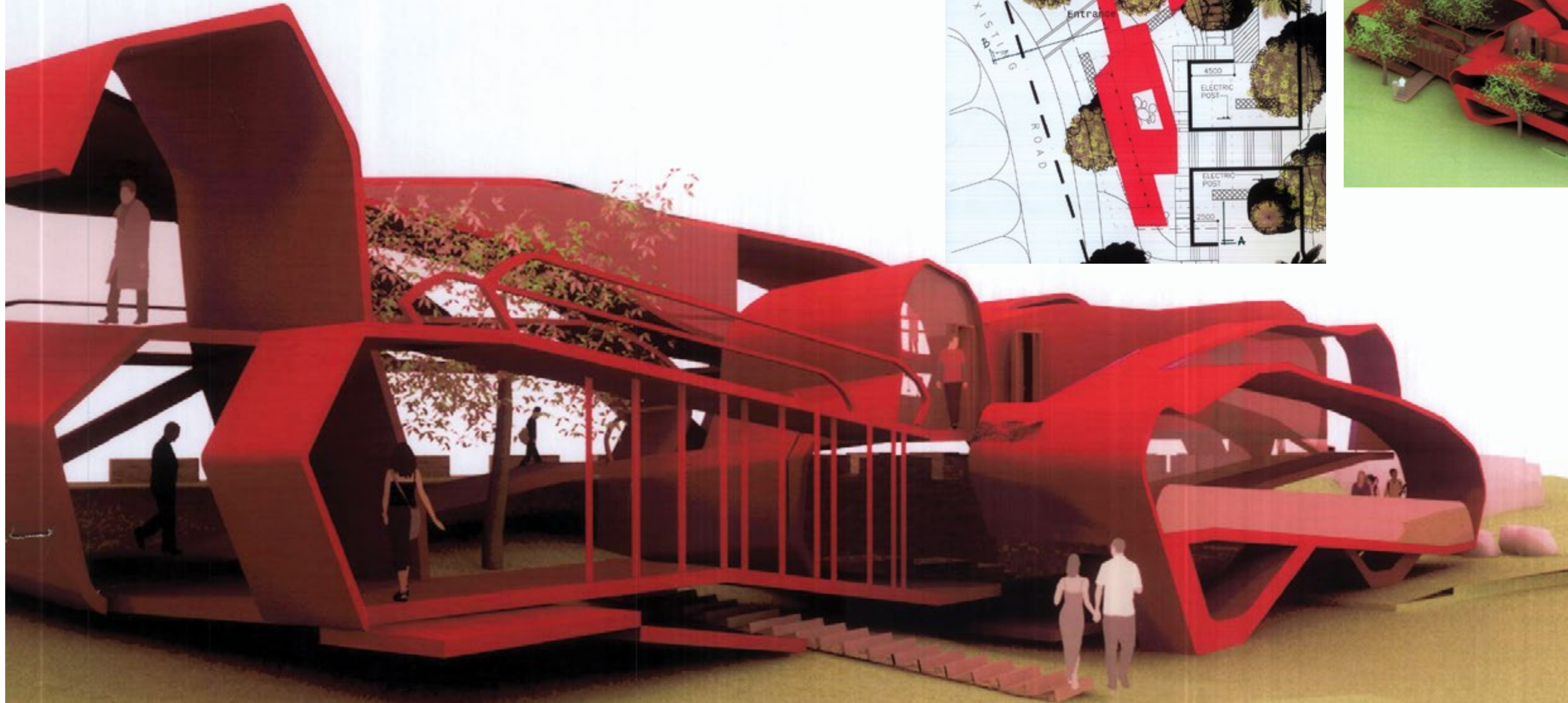

Respecting the site is something very apparent in this design. It is part of the project's requirement that the existing green on site be respected. It is not just blending within the new upcoming architecture. Mutual respect and response to the context and the surroundings are elements which good architecture is based upon. This scheme successfully carries itself on this premise and produces an architecture that eventually promotes the exploration of the past in its original context.

■ Huszazaifah Hussin